



# AFFECT THEORY CONFERENCE

WORLDINGS | TENSIONS | FUTURES  
OCTOBER 14-17, 2015

MILLERSVILLE UNIVERSITY'S WARE CENTER  
-----  
LANCASTER, PA

## **LIST OF #affectWTF CREDITS**

### **Conference Core Committee:**

**Gregory J. Seigworth, Lisa Marie Blackman, & Heather Love**

### **Conference Preparation/Labor and Van Driving:**

**MURG (Millersville University Read Group)**

### **Three People Who Consistently Went Well Above and Beyond in Every Way:**

**Jacqueline Benn Seigworth (eternal confidant & partner in crime)**

**Kendall Seigworth (future of sociology/anthropology)**

**Kim Guasco (departmental administrative assistance extraordinaire)**

### **Website Design/Maintenance & master of conference media/social media:**

**Audrey Ventura**

### **Registration management, pay buttons, & all-purpose troubleshooting:**

**DJ Ramsey**

### **Funding Support:**

**Dean Dr. Diane Zimmerman Umble of the College of Arts, Humanities and Social Sciences (initial push, unshakeable belief, and generous start-up funds!)**

**Department of Communication & Theatre**

**Department of English**

**Department of Philosophy**

**Department of Art & Design**

Thank you of course to **Millersville University** administration and staff for managing the flow of paperwork and steady stream of adventures. Special thanks also to the **Ware Center** staff – especially **Laura Micciche** (for meetings, emails, devil's advocacy, & attention to every detail).

### **Local Lancaster businesses (shout-out!):**

**Commonwealth on Queen (caterer – Rachael!)**

**The Seed restaurant (host of Thursday night workshop)**

**Tellus360 (site of the Wednesday opening reception – Bill!)**

**Mecks Produce (morning fruit)**

**Foundation PrintWork (t-shirts – Eric!)**

**Building Character/Madcap & Co (#affectWTF fridge magnets – Marty!)**

### **Special thanks:**

**Rob Spicer** (right-hand man, maker of spreadsheets, and van coordinator), **Marie Cartwright** (Harrisburg airport liaison), **Emi Laufer** and **Johnny Gainer** (security blankets [and more!] for the actual conference days), **Mark Mullen** (technician of overflow), **Ken Wissoker** (early & consistent provider of advice and insights), **Gil Rodman** (phone-a-friend-conference-wisdom-&-supreme-collegiality), **Mike Jarrett** (perpetual sounding board) and **Claire Giblin** (for permission to use her amazing and beautiful art on mundane things like t-shirts and even refrigerator magnets).

### **EXTRA SPECIAL THANKS:**

To **ALL OF THE CONFERENCE PLENARIES** who agreed to come and participate in #affectWTF and to do so without any honorarium for their time/labor. Without them, this conference would just have been WTF.

**Affect Theory: Worldings/Tensions/Futures**  
**Wednesday – Saturday, Oct 14-17, 2015**  
Millersville University's Ware Center

**CONFERENCE OVERVIEW**

**WEDNESDAY, OCT 14**

Rolling Drop-In Registration (Tellus 360): Starts 6 – 10:30 pm.

Informal Welcome w/ a few remarks at 7:45 pm: Greg Seigworth

**Wreck the Formats.** Approximately 8-9 pm.

Hors d'oeuvres/cash bar/music/mingling continues until 10:30 pm @ Tellus 360

**THURSDAY, OCT 15** -- Registration 7:30 am - 3 pm in Ware Center Lobby. Coffee, water, fruit, snacks, etc.

- |                 |  |
|-----------------|--|
| 8:20 – 10:00    | I. 1-4 Four concurrent panels (4-5 people each)                                      |
| 10:15 – 10:30   | Welcome: Dean Diane Umble & Gregory J. Seigworth (Steinman)                          |
| 10:30 – 12:00   | Plenary #1: <u>Lisa Blackman &amp; Heather Love</u> (Steinman)                       |
| 12:00 – 1:00    | Box-lunch (in lobby; can be carried outside or into any classroom, not Steinman)     |
| 1:00 – 2:40     | I. 5-8 Four concurrent panels (4-5 people each)                                      |
| 2:55 – 4:35     | Spotlight Session: <u>Ann Cvetkovich</u> with <b>Stream #2 Panel 1</b> (Atrium)      |
| 4:50 – 7:05     | Plenary #2: <u>Lawrence Grossberg &amp; Jason Read &amp; Jeremy Gilbert</u> (Atrium) |
| 7:05 – infinity | Dinner (on your own around the city)   |

**FRIDAY, OCT 16\*** -- Registration 7:30 am - 3 pm in Ware Center Lobby. Coffee, water, fruit, snacks etc

- |               |  |
|---------------|--|
| 8:20 – 10:00  | II. 1-6 Six concurrent panels  |
| 10:15 – 11:55 | II. 7-12 Six concurrent panels   |
| 11:55 – 1:25  | Lunch (Lancaster Central Market & elsewhere)                                       |
| 1:25 – 3:05   | II. 13-18 Six concurrent panels  |
| 3:20 – 4:50   | Plenary #3: <u>Lauren Berlant &amp; Katie Stewart</u>                              |
| 5:05 – 6:45   | II. 19-24 Six concurrent panels  |
| 6:45 – 8:45   | Dinner (on your own around the city) [PhD workshop: <u>Ann Cvetkovich LL1-04</u> ] |
| 8:45 – 11:00  | Plenary #4: <u>Tavia Nyong'o &amp; Zizi Papacharissi &amp; Shaka McGlotten</u>     |

**SATURDAY, OCT 17\*** -- Registration from 7:30 am – noon in Ware Center lobby. Coffee, water, fruit, snacks etc

- |               |   |
|---------------|---|
| 8:20 – 10:00  | III. 1-6 Six concurrent panels  |
| 10:15 – 12:30 | Plenary #5: <u>Patricia Clough &amp; Jasbir Puar &amp; Ben Anderson</u> |
| 12:30 – 1:45  | Lunch (Lancaster Central Market & elsewhere)                            |
| 1:45 – 3:25   | III. 7-12 Six concurrent panels   |
| 3:40 – 5:10   | Plenary #6: <u>Melissa Gregg &amp; Natasha Dow Schull</u>               |
| 5:25 – 7:05   | III. 13-18 Six concurrent panels  |
| 7:05 – 8:45   | Dinner (seasonal soups/bread) [PhD to Book: w/ Ken Wissoker]            |
| 8:45 – 11:00  | Plenary #7: <u>Erin Manning &amp; Brian Massumi &amp; Steve Shaviro</u> |

# STREAM INDEX\*

## **STREAM 1 – Psychoanalysis, Affect, Time** (organized by Lisa Baraitser and Katie Gentile)

- 2-3 Friday, Oct 16 8:20 am [Grand Salon]
- 2-21 Friday, Oct 16 5:05 pm [Grand Salon]
- 3-12 Sat, Oct 17 1:45 pm [Lower Level 1-02]

## **STREAM 2 – Black Affects and Minor Feelings** (organized by Rizvana Bradley)

- 1-2 Thurs, Oct 15 8:20 am [Grand Salon]
- Spotlight Thurs, Oct 15 2:55 pm [Atrium]
- 2-22 Friday, Oct 16 5:05 pm [Choral]
- 3-14 Sat, Oct 17 5:25 pm [Atrium]

## **STREAM 3 – Affective Capitalism** (organized by Mona Mannevuio and Tero Karppi)

- 1-8 Thurs, Oct 15 1 pm [Binns]
- 2-19 Friday, Oct 16 5:05 pm [Steinman]
- 3-3 Sat, Oct 17 8:20 am [Grand Salon]
- 3-7 Sat, Oct 17 1:45 pm [Steinman]

## **STREAM 4 - Affect and Practices of Power & Resistance in Latin America & the Global South** (organized Susana Wappenstein and Virginia Villamediana)

- 2-16 Friday, Oct 16 1:25 pm [Choral]
- 3-8 Sat, Oct 17 1:45 pm [Atrium]

## **STREAM 5 – Media | Mediation | Affect** (organized by Sarah Cefai)

- 1-6 Thurs, Oct 15 1 pm [Grand Salon]
- 2-5 Fri, Oct 16 8:20 am [Binns]
- 2-11 Fri, Oct 16 10:15 am [Binns]
- 3-1 Sat, Oct 17 8:20 am [Steinman]

## **STREAM 6 – Posthuman Affects in 21<sup>st</sup> Century Feminist Production** (organized by Libe García Zarranz & Belén Martín-Lucas)

- 2-10 Fri, Oct 16 10:15 am [Choral]
- 2-18 Fri, Oct 16 1:25 pm [LL1-02]
- 3-16 Sat, Oct 17 5:25 pm [Choral]

## **STREAM 7 - Affect and Its Queer Intersections: Race, Trans, and Biopolitics** (organized by Eliza Steinbock, Kyla Schuller, & Aren Aizura)

- 2-12 Fri, Oct 16 10:15 am [LL1-02]
- 2-14 Fri, Oct 16 1:25 pm [Atrium]
- 3-2 Sat, Oct 17 8:20 am [Atrium]

## **STREAM 8: Affect Theory and Arts-Based Research: *The Event of Poïesis*** (organized by Kristopher Holland & Nandita Baxi Sheth)

- 2-9 Fri, Oct 16 10:15 am [Grand Salon]
- 3-4 Sat, Oct 17 8:20 am [Choral]

## **STREAM 9 - Affect, Identity, & Resistance within the Neoliberal Academy** (organized by Emanuelle Wessels)

- 2-15 Fri, Oct 16 1:25 pm [Grand Salon]

## **STREAM 10 – Reading Human Rights & Literature Through Affect: a decolonizing approach** (organized by Élise Couture-Grondin)

- 3-17 Sat, Oct 17 5:25 pm [Binns]

**STREAM 11 - Ordinary Affect and Everyday Life** (organized by Julie Wilson and Emily Chivers Yochim)

1-4        Thurs, Oct 15 8:20 am [Binns]  
1-7        Thurs, Oct 15 1pm [Choral]  
2-20      Fri, Oct 16 5:05 pm [Atrium]  
3-5        Sat, Oct 17 8:20 am [Binns]

**STREAM 12 – Listening as Worlding: Sound Knowledge and Its Translation** (organized by Deborah Kapchan)

1-1        Thurs, Oct 15 8:20 am [Atrium]  
2-8        Fri, Oct 16 10:15 am [Atrium]  
2-13      Fri, Oct 16 1:25 pm [Steinman]

**STREAM 13 - Engaging Religious & Secular Affect** (organized by Sophie Bjork-James & Yunus Doğan Telliel)

2-4        Fri, Oct 16 8:20 am [Choral]  
3-13      Sat, Oct 17 5:25 pm [Steinman]

**STREAM 14 – Art and “Urban” Textures: The City & Affective Experimentation** (organized by Caitlin Bruce)

2-1        Fri, Oct 16 8:20 am [Steinman]  
3-9        Sat, Oct 17 1:45 pm [Grand Salon]

**STREAM 15 - Practising Affect: Exercises, Techniques, Methodologies** (organized by Casey Boyle)

1-3        Thurs, Oct 15 8:20 am [Choral]  
2-17      Fri, Oct 16 1:25 pm [Binns]  
3-11      Sat, Oct 17 1:45 pm [Binns]

**STREAM 16 - Ancient/Medieval Genealogies of Affect** (organized by Emanuela Bianchi)

3-18      Sat, Oct 17 5:25 pm [LL1-02]

**STREAM 17 – Affective Ecologies and Everyday Outdoor Activities** (organized by Matthew Tiessen)

2-6        Fri, Oct 16 8:20 am [LL1-02]  
3-10      Sat, Oct 17 1:45 pm [Choral]

**STREAM 18 – Feeling Mobilities / Mobile Feelings** (organized by Luis-Manuel Garcia & Dorina M. Buda)

2-23      Fri, Oct 16 5:05 pm [Binns]  
3-15      Sat, Oct 17 5:25 pm [Grand Salon]

**STREAM 19 – FTW (For The Win, or, the Wayward)** (organized by the Conference Core Committee)

1-5        Thurs, Oct 15 1 pm [Atrium]  
2-2        Fri, Oct 16 8:20 am [Atrium]  
2-7        Fri, Oct 16 10:15 am [Steinman]  
3-6        Sat, Oct 17 8:20 am [LL1-02]

**WRECK THE FORMAT panel**

2-24      Fri, Oct 16 5:05 pm [LL1-02]

**\*THANKS TO ALL STREAM ORGANIZERS! They made the task of sorting, evaluating, and coordinating the nearly 700 submissions to this conference all that easier to accomplish!**

# **INDEX for Wreck-The-Formats**

## **WTF MOVES!**

**WTF! Guided Movement Sessions to Increase Embodied Awareness (The Yin of Affect)** – Jennifer Lin LeMesurier (Colgate University) – Friday and Saturday 8–8:20 am, left side of Upper Grand Foyer (behind Steinman Auditorium); drop-in attendance (and the group can decide about meeting again later in the day if desired)

## **WTF INSTALLATIONS!**

**WTF! To Sit Without Echoes: What is the Affect of an Anechoic Chamber?** – Peter McMurray, Matthew Battles, & James Yamada (Harvard /metaLab) + Michael Heller (U of Pittsburgh) ... in the Regitz Gallery Friday and Saturday

**WTF! The Habermas Machine** – Kristopher J. Holland (U of Cincinnati) in the Regitz Gallery: Friday & Saturday

**WTF! Impression/Mobius Strip** – Maya Pindyck & Kay Gordon (Columbia U) ... in the Regitz Gallery Friday and Saturday

## **WTF WORKSHOPS!**

**WTF! Navigating Through Social Distance: A Relational Exercise in Race and the Rip-** Kenneth Bailey and Lori Lobenstine, Design Studio for Social Intervention (DS4SI) & Anique Vered (SenseLab) ... Thurs night 8:30-10:30 pm (The Seed Co-op)

**WTF! Touchy Matters: Writing about Online Baits & Triggers** – Theresa Senft (NYU) ... Friday 10:15-12:15 in Ware Center Room 3-05

**WTF! Affective Architecture Workshop: Support Structure** - Julian Carter (California College of Arts), Rebekah Edwards (Mills College), Michelle LaVigne (U of San Francisco) & Selby Schwartz (Stanford U) ... Friday 1:30-3:00 pm Ware Center's von Hess Library Room (2<sup>nd</sup> floor)

**WTF! Writing Practice as Affect Theory: A Public Feelings Salon** – Ann Cvetkovich (UT-Austin) ... Friday 6:45-8:45 pm (catered meal over the dinner break; pre-registration - SOLD OUT! With waiting list) – von Hess Library Room

**WTF! Sticky Currents: Drawing Folds in Serial Exhaustion** - Nicole De Brabandere (Zurich University of the Arts) Friday 6:45 pm Lower Level 1-04

**WTF! Movable Noisy Spaces** – Bianca Scliar of Moinho de Danças / SenseLab (State University of Santa Catarina, Brazil) Saturday 1:45-2:25 pm Lower Level 1-04 (30-40 minute walk/rhythmanalysis of Ware Center's architectural landing sites)

## WTF INTERACTS!

### **WTF! Poems of Love and Letters of Recommendation – Miranda Texidor**

(Visual Artist: Quito Ecuador) – portico and front walkway of the Ware Center ...  
Friday & Saturday throughout the day

**WTF! Landing in the Stream – with SenseLab participants** – A WTF movement that cuts through site and scales of attention, modulating the event. Join us for a first exploration of techniques in the making. *First Departing Iteration* on the main first upper grand foyer at 10:30 am on Friday... & through Saturday (*as other Distributed Iterations* reverberate along the days).

**WTF! The Author is in Pain: Encountering the Non-Belonging Body– Vyshali Manivannan** (Rutgers) – Saturday 8:20 am Lower Level 1-02 (paper/performance as part of a panel on Pain / Triggers / Intensity)

**WTF! KETL: forays in affective futures – Michael Hornblow + Melora Koepke** (SenseLab) – Saturday afternoon around the covered portico of the Ware Center, and then 7:05-8:45 pm in the Firestone parking lot behind the Ware Center (208 West Orange St)

## WTF SPEAKS!

### **WTF! Wednesday opening reception from 8-9 pm. Tellus 360.**

- **Paulina Laguera and Colleen Daly** / Face With a View
- **Anna Gibbs** / Whimper [a video version of this performance will also loop in the Regitz Gallery]
- **Isabel Waidner** / Gaudy Bauble
- **Josephine Anstey** / Improving Consciousness (IMPCON)
- **Gilbert B. Rodman** / The Imaginarium of Professor Seigworth

### **WTF! Friday 5:05-6:45 pm: Evocations / Provocations. Grand Salon.**

- **Donora Hillard-Hare** / The Aphasia Poems
- **Bianca Scliar** / Moveable Noisy Spaces
- **Ligia Lewis** / Sensation 1 [a taped performance that loops on a monitor in Regitz Gallery]

# **WEDNESDAY, OCTOBER 14**

**6:00 pm – 10:30 pm**

## **ROLLING DROP-IN REGISTRATION AND OPENING RECEPTION @ Tellus360 (24 East King Street)**

Informal Welcome with a few orienting/housekeeping remarks at 7:45 pm: Greg Seigworth

**Wreck the Formats.** Approximately 8-9 pm, interspersed throughout the evening.

- **Paulina Laguera and Colleen Daly** / Face With a View
- **Anna Gibbs** / Whimper
- **Isabel Waidner** / Gaudy Bauble
- **Josephine Anstey** / Improving Consciousness (IMPCON)
- **Gilbert B. Rodman** / The Imaginarium of Professor Seigworth

Hors d'oeuvres/cash bar/music/mingling continue until 10:30 pm.

# **THURSDAY, OCTOBER 15**

**CONFERENCE REGISTRATION OPENS AT THE WARE CENTER @ 8 am, Thursday October 15.**

## **PANELS: THURSDAY OCT 15 – 8:20 until 10:00 am**

**(underlined name on panel indicates 'panel chair')**

### **1-1: Sound Affects, Sexualized Listening & New Worldings (S12) – ATRIUM (Deborah Kapchan)**

- **Michaela Frischherz** / Listening to Orgasm: Translating Pleasure's Affects in Women's Visual/Aural Narratives
- **Emma Leigh Waldron** / "It FEELS SO REAL!": Sense and Sexuality in ASMR Videos
- **Barbara Browning** / Listening to People Listening
- **Ana Pais** / The politics of encounter: Listening as intensification of affect
- **Charmian Wells** / Listening for the Break: The Kinetic-Sound Body

### **1-2: Exploring the Affective Dimensions of Black Political Thought: Optimism, Loss, Hope, Moodiness (S2) – GRAND SALON (Rizvana Bradley)**

- **John Drabinski** / Baldwin Between Optimism and Pessimism
- **Nijah Cunningham** / Specters of Malcolm: Elegy, Affect, and the Echo of Other Worlds
- **Seulghee Lee** / Critical Moodiness in/as Blackness
- **Jared Bly** / Becoming-Colonized, Becoming-African, Becoming-Black

### **1-3: The Body Politic/The Politic as Body (S15) – CHORAL**

- **Sharon Avital** / Happiness as Resistance
- **Sarah Richter** / Anarchist Affects: Performing the Fragment
- **Astrid Schrader** / Abyssal Logics: Microbial Deaths and Affect in Scientific Practices

### **1-4: Out of the Ruins: Place, Affect, and Everyday Worldings (S11) – BINNS (Emily Chivers Yochim)**

- **Melissa R. Meade** / Affect and Extraction in the Anthracite Coal Region of Northeastern Pennsylvania
- **Kim Smith** / It Doesn't Get Better: Slow Death, Crude Oil, and Hopeless Prairie Hearts
- **Lindsey Freeman** / Ordinary Affects in the Atomic City
- **Sabrina Lilleby** / Contemporary Cairo: In the Encounter Between Extraordinary Happenings and Ordinary Affects

***OPENING WELCOME: Dean Diane Umble & Gregory J. Seigworth 10:15-10:30 am (Steinman Hall)***



**PLENARY #1: LISA BLACKMAN & HEATHER LOVE 10:30-12:00 noon**  
**(Steinman Hall – Chair: Greg Seigworth)**

**BOX LUNCH PROVIDED – LUNCH BREAK 12:00 – 1 pm**

**PANELS: THURSDAY OCT 15 – 1:00 until 2:40 pm**

**1-5: How like an animal (S19) – ATRIUM**

- **Dominic Pettman** / Creaturely Love: How Desire Makes Us More and Less Than Human
- **Jody Berland** / But in my dreams began to creep that old familiar “tweet tweet tweet”
- **Dorthe Staunæs** / “May the horse be with you.” Posthuman encounters and the methodology of listening
- **Ben De Bruyn** / Affective Environments: Listening to Animals in Contemporary Fiction

**1-6: Publics / Preparedness (S5) – GRAND SALON (Sarah Cefai)**

- **Jennifer Coates** / Mediating Memory: The ‘Presumed Shared Experience’ of War Trauma in Classical Narrative Japanese Cinema
- **Melissa Ames** / Remediating National Tragedies (from 9/11 to Ferguson) on the Small Screen: Using Affect Theory to Study Contemporary Television Trends
- **Michael Richardson** / Encountering Radical Absence: Traumatic Affects in the Digitally Mediated Experience of Disappearance
- **Steen Christiansen** / Action Movies’ Worlding

**1-7: Structures of Feeling and Everyday Gender Lives (S11) – CHORAL (Julie Wilson)**

- **Sarah Banet-Weiser and Laurie Ouellette** / Affective Feminism and Everyday Life
- **Erin J. Rand** / The Dapper Affect Alien’s Neoliberal New Clothes
- **Jamie Hakim** / The Spornosexual: Affect and Male Embodiment During Neoliberal Austerity
- **Frederika Thelandersson** / Sad to the Core: Creating Collectivity around Everyday Sadness
- **Jimmie Manning** / The Pain of Pure Potential: Affective Assemblage, Notions of Family, and the Fluid Meaning of Purity Rings

**1-8: Labor (S3) – BINNS (Tero Karppi)**

- **Tyler Hinson** / From Art to Administration: Graphic design and the organization of affect in the cultural industries
- **Emily West** / Affect Theory and Advertising
- **Kristin Swenson** / “Willing Slaves of Capital” to “Willful Subjects” Against Capital
- **Donald Hedrick** / Inventing Affect: The Origins of Fun and the Commodification of Boredom-Labor

**SPOTLIGHT PANEL in Ware Center Atrium 2:55 – 4:35 pm**

**Accumulated Affects: Blackness, Gender, and Sexual Difference in the Writing and Performing of Non-Normative Feeling (Rizvana Bradley) (S2)**

- **Ann Cvetkovitch** / Documenting Ordinary Racism: Writing Practice as Affect Theory
- **Amber Musser** / The Space of Indeterminacy: Theorizing the Mother
- **Zakiyyah Jackson** / Sense of Things
- **John Steen** / Feeling’s Injury: Claudia Rankine and the Uncontainable

**PLENARY #2: LAWRENCE GROSSBERG, JASON READ & JEREMY GILBERT 4:50 – 7:05 pm (Atrium – Chair: Jennifer Daryl Slack)**

***Conference (except for a workshop) adjourns for the evening at 7:05 pm.***

**WTF! Navigating Through Social Distance: A Relational Exercise in Race and the Rip- Kenneth Bailey and Lori Lobenstine, Design Studio for Social Intervention (DS4SI) & Anique Vered (SenseLab)**  
... Thurs night 8:30-10:30 pm (The Seed Co-op)

\*\*\*\*\*

## **FRIDAY OCTOBER 16**

**COFFEE & REGISTRATION – OPEN AT THE WARE CENTER @ 8 am**

**WTF! Guided Movement Sessions to Increase Embodied Awareness (The Yin of Affect) – Jennifer Lin LeMesurier** (Colgate University) – Friday and Saturday 8–8:20 am, left side of Upper Grand Foyer (behind Steinman Auditorium); drop-in attendance (and the group can decide about meeting again later in the day if desired)

**WTF! Poems of Love and Letters of Recommendation – Miranda Texidor** (Visual Artist: Quito, Ecuador) – portico and front walkway of the Ware Center ... Friday & Saturday

### **WTF INSTALLATIONS!**

**WTF! To Sit Without Echoes: What is the Affect of an Anechoic Chamber? – Peter McMurray, Matthew Battles, & James Yamada** (Harvard /metaLab) + **Michael Heller** (U of Pittsburgh) ... in the Regitz Gallery Friday and Saturday

**WTF! The Habermas Machine – Kristopher J. Holland** (U of Cincinnati) in the Regitz Gallery: Friday & Saturday

**WTF! Impression/Mobius Strip – Maya Pindyck & Kay Gordon** (Columbia U) ... in the Regitz Gallery Friday and Saturday

### **PANELS: FRIDAY OCT 16 – 8:20 until 10:00 am**

**2-1: Curating Contingency: Art Programming as Affective Intervention and Urban Experimentation (S14) –**

**STEINMAN AUDITORIUM (Caitlin Bruce)**

- **Elena Basile and Roberta Buiani** / Turning space into place. Thinking through an experiment in affective mapping
- **Salma Abdel Salam** / Moving and Sounding: Gesticulating the Limits of Civility
- **Jennifer Fisher** / Curating Affect in Museum Interventions and Civic Spectacle
- **Julian Brash** / Engineering Affect: Design, Experience, and Politics on the High Line
- **Erin Siodmak** / Aesthetic Encounters in Urban Space: The Heidelberg Project (Tyree Guyton, Detroit, 1988-ongoing)

**2-2: Querying Fluidities: an affective aesthetics of space / touch / habit (S19) – ATRIUM**

- **S. Pearl Brilmyer** / 'Necessities of Attraction and Desire': Félix Ravaisson and the Affective History of Habit
- **Mark Paterson** / On sensation, affect, and motor habits in Ravaisson and Bergson. Habit-bodies.
- **Tonya Davidson** / Tracing the Affective Work of Monuments: Unmapping as a Methodological Practice
- **Andrej Radman** / Affective Warping of Manifolds: No Movement, No Brain

**2-3: Sexualities, memories, shame (S1) – GRAND SALON (Tom Roach)**

- **Claudia Breger** / Slow Worldings: Unfolding Affective Complexity in Fassbinder's *Katzelmacher*
- **Marlee Fuhrmann** / A Chaste Affair: Resisting Hetero-Chrononormativity in the Novel
- **Bogdan Popa** / No need for temporality in queer life? Owen Renik's mistakes and Judith Butler's resignification of shame
- **Peter Rehberg** / Drive, Pleasure, Affect: Sexual Temporalities in Post-Pornography
- **Natalie Haziza** / 'Under Erasure': William Kentridge and Post-apartheid South Africa

**2-4: Figurations: Affective Circulation and the Religious (S13) – CHORAL**

- **Ronald Walter Greene and Darin Hicks** / The Affective Economy of Conviction

- **M. Gail Hammer** / The Cultural Work of Religion Documentaries: Deploying Affect to (re)Draw the Normative Boundaries
- **Josh Brahinsky** / Pentecostal Practice and the Non-volitional Bent of Affect Theory
- **Yunus Doğan Telliel** / Calling Muslims: Affective Politics and Ritual Words

## 2-5: Techné (S5) – BINNS (**Sarah Cefai**)

- **Elizabeth Stephens** / Affective Machines: Towards an Organology of the Screen
- **Ryan Sheldon** / Shot Reverse Shot: Slow Violence, Spectacular Warfare, and the Body on Screen
- **Misha Kavka** / The Affective Screen or Wearable Tech, or What Ever Happened to Google Glass?
- **Mack Hagood** / Administer Aurally: Tinnitus and Orphic Media

## 2-6: Affective Ecologies Gone Wild (S17) – LOWER LEVEL 1-02 (**Matthew Tiessen**)

- **Stephanie Erev** / What is it Like to Become a Bat? Transspecies Affects in an Age of Extinction
- **Emily Roehl** / 'The Outlines of Impacts Suffered': Performing the Petrochemical Landscape
- **Bridget Guarasci** / Birding Under Fire: Iraq's Marsh Restoration during the Recent War
- **Courtney O'Dell-Chaib** / Desiring Devastated Landscapes: Affective Intimacies After Ecological Collapse

**WTF! Touchy Matters: Writing about Online Baits & Triggers** – Theresa Senft (NYU) ... Friday 10:15-12:15 in Ware Center Room 3-04

**WTF! Landing in the Stream** – with **SenseLab** participants – A WTF movement that cuts through site and scales of attention, modulating the event. Join us for a first exploration of techniques in the making. *First Departing Iteration* on the main first upper grand foyer at 10:30 am on Friday... & through Saturday (as other *Distributed Iterations* reverberate along the days).

## **PANELS: FRIDAY OCT 16 – 10:15 until 11:55 am**

### 2-7: In the Gap: Time and Glitch (S19) – STEINMAN AUDITORIUM

- **Steven D. Brown and Paula Reavey** / Vital Memory and Affect: Living with a difficult past
- **Jenny Sundén** / Affect Glitch
- **Anu Koivunen** / Affective Historiography: Time, Trauma, and Transference
- **William Bogard** / The Caesura or Break in Time

### 2-8: Worlds of Affect: Listening as Worlding (S12) – ATRIUM

- **Srdan Atanasovski** / Democracy of the Flesh: Urban Soundscapes and the Affective Life of the Subject
- **Margret Grebowicz** / Smart Devices and Interspecies Curiosity; or: How Can We Talk to Dolphins if We Can't Talk to Each Other?
- **Deborah Kapchan** / Slow Ethnography, Slow Activism: Listening and the Longue Durée
- **Lisbeth Lipari** / Interlistening & the Tout Ensemble

### 2-9: An Inventory of Affects for Arts Based Research (S8) – GRAND SALON

- **Kristopher Holland** / Sifting Foundational Ruins: An Inventory of Affects for Art-Based Research
- **Janae Sholtz** / How Can We Make Ourselves Sensitive to Immanence and the Fluidity of Thought? A Fluxus Art-Affect of Indeterminacy
- **Lindsey Lodhie** / Artificial Tears: Affective Media as Laboratory Mise-en-Scene
- **Paula Caspão** / Research Affects: An inter-choreographic perspective
- **Kristen Mundt** / Decolonizing Landscapes: Peripatetic Cultural Production and the Power of the Ordinary

### 2-10: Feminist Archives of Sustainable Affects (S6) - CHORAL

- **Jami Weinstein** / Vital Affects: A Theory of Indifference Ethics for Posthumous Lives
- **Melissa Deem** / Historical Stutters: Affective Autopsy and the Resurrection of a Feminist Archive
- **Marina Levina** / Post-Apocalypse/Post-Affect: Kinships and Re-Productive Imaginaries in Feminist Science Fiction

**2-11: The Missing (S5) – BINNS (Ben Anderson)**

- **Rebecca Adelman** / Fictive Intimacies of Detention: Mediation, Affect, and the Activist Imagination of Guantánamo Bay
- **Joy James** / Distance, Intimacy, and Affective Knowledges
- **Sarah Cefai** / Disappearing Acts: Biopolitics and Material Images
- **Kerry Whigham** / Occupying Space, Amplifying Affect: The American Indian Occupation of Alcatraz Island

**2-12: Queer Materiality (S7) – LOWER LEVEL 1-02 (Eliza Steinbock)**

- **Gillian Harkins** / Out of the Woods: White Pedophiles and the Limits of Vile Sovereignty
- **Hilary Malatino** / Feeling Better: Gendered Becoming, Microprosthetics, and Neocolonial Necropolitics
- **Kyla Schuller** / Vaginal Impressions: Civilized Sexuality and the Historicity of Affect
- **Jeanne Vaccaro** / Money's Doodles

***LUNCH BREAK 11:55-1:25 pm***

**WTF! Wreck: Affective Architecture Workshop - Julian Carter** (California College of Arts), **Rebekah Edwards** (Mills College), **Michelle LaVigne** (U of San Francisco) & **Selby Schwartz** (Stanford U) ... Friday 1:30-3:00 pm Ware Center's von Hess Library Room (2<sup>nd</sup> floor)

**PANELS: FRIDAY OCT 16 – 1:25 until 3:05 pm**

**2-13: Listening to Technical and Tactical Worlds (S12) – STEINMAN AUDITORIUM (Deborah Kapchan)**

- **Nick Bazzano** / On Holding On-Hold: Sound, Affect, Attunement, Acceleration
- **David Cecchetto** / Listening away from twenty-first century media
- **Michael Heller** / "What is the Affect of an Anechoic Chamber? Pt. 1: Wedge, Ping, Bat, Cage"
- **Eldritch Priest** / Sonic Contagions and Libidinal Technics

**2-14: Trans Affect (S7) – ATRIUM (Kyla Schuller)**

- **Ido Katri** / Trans-Arab-Jew: The Affect of In-Betweenness and Exclusionary Law
- **Eliza Steinbock** / Micro-Analysis of Trans\* Visual Activists: On Affective Exchange in Researching Portraiture
- **Abram J. Lewis** / Trans Animisms
- **Aren Aizura** / Affective Vulnerability, Risk, and Debt

**2-15: Managing Work and Self through Affective Engagements: Researching, Teaching, and Living in the Neoliberal Academy (S9) – GRAND SALON (Anna Gibbs)**

- **Rob Shields** / Affect and neoliberal governance: Academic Research and the Birth of the Nanopolitical
- **Mark James** / Feeling the Problem: Working through Diversity Work
- **Naomi Greyser** / Writing through Writer's Block: Race, Gender and Affective Obstacles in a Neoliberal Academy
- **Jennifer Sano-Franchini** / "It's Like Being in a Co-Dependent Relationship with Someone Who Doesn't Even Want You!": Affect, Emotional Labor, and the Academic Job Market in Rhetoric and Composition

**2-16: Method and Affects in the Aftermaths of Violence (S4) – CHORAL**

- **Cecilia Macón** / On Not To Talk: Hope and Joy as Resilience. The Case of Female Victims of Sexual Violence in the Argentinian Crimes Against Humanity Trials
- **Kaitlin Murphy** / Memory, Performance, and the Politics of the Visual
- **Alana Vehaba** / Reaching Out to Palden: An Incomplete Methodology for Meeting a Tibetan Self-immolator
- **Susana Wappenstein** / States of Reconciliation: Affect in Colombia's Post-Conflict
- **Audrey Winpenny** / Aphonic Ethnography: Plumbing Subterranean Affects Within Narco-landia

## **2-17: Techné of Movement (S15) - BINNS**

- **Carolina Cambre** / Transsemiotic Worldings: Toward process centered (anarchic) visual methodologies
- **Casey Boyle** / Gilbert Simondon, Rhetoric & Transductive Practice
- **Jennifer Lin LeMesurier** / Practising Bodies: Drawing on Affect in Dance Pedagogy
- **Jana Rosinski** / Instruments of Intensity: Visualizing Affect

## **2-18: Affective Entanglements: Feminist Production that Matters (S6) – LOWER LEVEL 1-02**

- **Margaret E. Toye** / Re-imagining Feminist Theories of 'love' in a Post Human World
- **Alecia Jackson and Lisa Mazzei** / Erin Manning's 'Bodying' at the Intersection of Posthumanism and Material Feminisms
- **Belén Martín-Lucas** / Cyborgian and Monstrous Affects: Kinship by Affinity in Canadian Feminist Speculative Fiction
- **M. Sofia Pimentel Biscaia** / 'Like Us:' Affirmative Posthuman Affects in Patricia Piccinini's Work

### ***PLENARY #3: LAUREN BERLANT & KATIE STEWART***

***3:20 – 4:50 Steinman Hall (Chair: Elizabeth Wilson)***

### **PANELS: FRIDAY OCT 16 – 5:05 until 6:45 pm**

## **2-19: Attention (S3) – STEINMAN AUDITORIUM**

- **Susanna Paasonen** / In the mood for distraction
- **Jonathan Doucette** / "Every Smile Counts": Digital Surveillance in the Emotion Economy
- **Liz Kinnamon** / Attention Under Repair: Asceticism from "Self-Care" to "Care of the Self"
- **Alison Hearn** / Verified: Twitter, identity management, and affective capitalism

## **2-20: Theorizing Affect in Everyday Lives (S11) – ATRIUM (Katie Stewart)**

- **Tahereh Aghdasifar** / Rhythms of the Banal: Tracing Everyday Erotics in Female Homosocial Spaces in Iran
- **Kerryn Drysdale** / Intimate Attunements: Everyday Affect in Sydney's Drag King Scene
- **Esther Hitchen** / Austere Environments: Developing a Micro-Politics of Austerity through Understanding it as Lived and Felt in Everyday Life
- **Julie Wilson and Emily Chivers Yochim** / Affective Infrastructures in Everyday Life: Mothers, Digital Media, and Precarity
- **Joseph C. Russo** / Gnarled Ecologies: Forms and Limits of the Ordinary

## **2-21: Temporal, Psychoanalytic, Affective Theories (S1) – GRAND SALON (Katie Gentile)**

- **Lisa Baraitser** / Psychic Time, Persistent Psychoanalysis
- **Gila Ashtor** / Telling Relational Time: Transference and the Ideology of Affect (A Laplanchean Critique)
- **Christa Binswanger and Andrea Zimmerman** / Queering the Palimpsest: affective interplay across time
- **Suzanne Cataldi Laba** / Remorse, Responsibility and The Sense of an Ending
- **Stephen M. Levin** / The Psychodynamics of Automatism: Theorizing the Inability to Play

## **2-22: Aesthetic Blackness (S2) – CHORAL**

- **Rizvana Bradley** / Some Notes on Abstraction, Flesh and Form
- **Soyoung Yoon** / Scraped Tablets?: The Fiction of Blackness in Jean Rouch's *The Human Pyramid* (1960)
- **Amalle Dublon** / In Excess of a "Proper Cause"
- **Nicole De Brabandere** / Sticky Currents: Drawing Folds in Serial Exhaustion

## **2-23: Circuits of Violence (S18) – BINNS (Luis-Manuel Garcia)**

- **Ali Colleen Neff & Sindhu Zagoren** / Fugitive Proximities: Mobile Media Practices and the Black Lives Matter Movement
- **Christine Lavrence** / Mobility, Empathy and Genocide Tourism
- **Amani Husain** / Border Affects and (Be)longing: Rethinking Strangers on the US-Mexico Border

- **Christopher Howard** / Feeling Vulnerable: Affective Atmosphere and Embodied Learning in Tourism Mobilities
- **Rachel E. Dubrofsky** / Auschwitz Selfie: Happiness and Death on Twitter

**2-24: Wreck the Format: Evocations / Provocations – LOWER LEVEL 1-02 (Robert Spicer)**

- **Donora Hillard-Hare** / The Aphasia Poems
- **Bianca Scliar** / Moveable Noisy Spaces
- **Ligia Lewis** / Sensation 1

**WTF! Sticky Currents: Drawing Folds in Serial Exhaustion** - Nicole De Brabandere (Zurich University of the Arts) Friday 6:45 pm Lower Level 1-04

***DINNER BREAK 6:45 – 8:45 pm***

**WTF! Writing Practice as Affect Theory: A Public Feelings Salon** – Ann Cvetkovich (UT-Austin) ...  
Friday 6:45-8:45 pm (catered meal over the dinner break; pre-registration - SOLD OUT! With waitlist) – Von Hess Library (2<sup>nd</sup> floor)

***PLENARY #4: SHAKA McGLOTTEN, TAVIA NYONG'O,  
& ZIZI PAPACHARISSI  
8:45 – 11:00 pm Steinman Hall (Chair: Tom Roach)***

***Conference adjourns for the day at 11 pm.***

# **SATURDAY, OCTOBER 17**

**COFFEE & REGISTRATION – OPEN AT THE WARE CENTER @ 8 am, Saturday October 17.**

**WTF!** Guided Movement Sessions to Increase Embodied Awareness (The Yin of Affect) – **Jennifer Lin LeMesurier** (Colgate University) – Friday and Saturday 8–8:20 am, left side of Upper Grand Foyer (behind Steinman Auditorium); drop-in attendance (and the group can decide about meeting again later in the day if desired)

## **PANELS: SATURDAY OCT 17 – 8:20 until 10:00 am**

### **3-1: Worldings (S5) – STEINMAN AUDITORIUM (Erin Manning)**

- **Sun-ha Hong** / The Experiencing 'I' and Parameters of Affection in the Online Surveillance Society
- **Lone Bertelsen** / The Productive Unconscious, Immediation and a New Micropolitics
- **Marc Boumeester** / Mediating Media: Superfolding Affective Registers as 'Veillance' in Post-Humanity
- **Andrew Murphie** / The World as Medium – Whitehead's Media Theory

### **3-2: Racializing Queer Affect (S7) – ATRIUM (Aren Aizura)**

- **Nael Bhanji** / Trans Necropolitics: Terrorism, Vigil/ance, and the Affective Geopolitics of Transsexual Memorialization
- **Colin Ashley and Michelle Billies** / Black Fugitivity and Queer Genocidality
- **Julian Gill-Peterson** / Flesh, or Organic Form: On the Cultivation of Trans of Color Critique

### **3-3: Money (S3) – GRAND SALON**

- **Joe Deville** / Following capitalism's affects: The case of consumer credit (and what affect theory can learn from STS)
- **Marcia Klotz** / Willful Submission and Capitalist Affect: What Money Wants Is You
- **John Andrews** / The Affective Politics of the Economy
- **Erik Bordeleau** / The Transindividual Collective at the End of the Economy

### **3-4: Articulation of Affect for Arts Based Research (S8) – CHORAL**

- **Nandita Baxi Sheth** / Affect and the Art Encounter: Art at the Speed of Slow
- **Andriko Lozowy, Rob Sheilds, Mickey Vallee** / Crystalizing the Canadian Tar Sands
- **Adrienne Boulton-Funke** / Nomadic Inquiry of School Spaces: Affect and the Aesthetics of Becoming
- **Megan O'Byrne** / "We Shall Overcome" to "Big Yellow Taxi": Music as Affective Art in an Environmental Social Movement

### **3-5: In the Impasses of Everyday Life: Refrains, Circuits, Survival (S11) – BINNS (Julie Wilson)**

- **Marnie Ritchie** / Cliche Clusters: Nine-Eleven Refrains as Ordinary Melodramas
- **Hollis Griffin** / Neoliberalism's Circuitry: Crisis Ordinarity and 'Every Day' Affect
- **Lindsey Whitmore** / Intoxicated Bodies, Ordinary Knowing: Exploring the Affective Politics of Drugs
- **Miranda Ganzer and Erin Siodmak** / Refrains that Change: Sex and Dynamism in Everyday Life
- **Chad Shomura** / Political Impassivities: Magnetic Affects, Dark Atmospheres, and Watching and Waiting at the End of a World

### **3-6: Pain / Triggers / Intensities (S19) – Lower Level 1-02**

- **Maria Mortensen** / When pain affects and bodies connect
- **Katariina Kyrola** / Trigger Warnings, Feminist Affects and 'Safe Space'
- **Vyshali Manivannan** / The Author is in Pain (WTF! performance/presentation)

**PLENARY #5: PATRICIA CLOUGH, JASBIR PUAR & BEN ANDERSON**  
**10:15-12:30 pm Steinman Hall (Chair: Jack Bratich)**

**LUNCH BREAK 12:30 – 1:45 pm**

**WTF! KETL: forays in affective futures** – Michael Hornblow + Melora Koepke (SenseLab) – begins Saturday afternoon around the covered portico of the Ware Center, and then 7:05-8:45 pm in the Firestone parking lot behind the Ware Center (208 West Orange St)

**WTF! Movable Noisy Spaces** – Bianca Scliar of Moinho de Danças / SenseLab (State University of Santa Catarina, Brazil) Saturday 1:45-2:25 pm Lower Level 1-04 (30-40 minute walk/rhythmanalysis of Ware Center's architectural landing sites)

**PANELS: SATURDAY OCT 17 – 1:45 until 3:25 pm**

**3-7: Encounters (S3) – STEINMAN AUDITORIUM (Tero Karppi)**

- **Tony Sampson** / Various Joyful Encounters with the Dystopias of Affective Capitalism
- **Yvette Granata** / Hauntology, Aesthetics, and Toys in Glass Globes: or Making Glitch Art with Derrida Instead
- **Marija Cetinić & Jeff Diamanti** / Four Genres of Affect Theory, or From Matter to Materialism
- **Eric Jenkins** / Addictions and Subscriptions: On the Waxing and Waning of Affect in Contemporary Capitalism

**3-8: Political Subjectivities, Citizenship and Affects (S4) – ATRIUM**

- **Mai Alkhamissi** / Journey to Quietism: Egypt's Independent Trade Unions and the Politics of Fear
- **Lisa A. Flores** / Performing Patriotism: The Affective Subjectivity of Mexican Braceros
- **Michael Lechuga** / Alienhood, Nomadism, and Challenging the Constitutive Citizenship Paradigm in the US
- **Mehdi Semati** / The Politics of Affect and the Republic
- **Virginia Villamediana** / A New Promise of Happiness: The Good Living of the 21st Century Socialism in Ecuador

**3-9: Re-Facing the Creative City: Affect, Economies, and Precarious Temporalities (S14) – GRAND SALON**

- **Paige M. Johnson** / The End of Affect? Anti-Busking Laws and the Changing Face of Street Performance in Yogyakarta
- **Caitlin Bruce** / Tour 13: From Precarity to Ephemerality, Affective Interventions in Temporalities of Creative Destruction"
- **Christine Bacareza Balance** / Walk This Way: Architecture, Memory, and Martial Law Philippines
- **Andie Shabbar** / From Graffiti to Ghosts: Queer Art as Affective In(ter)vention in Urban Space
- **Erica L. Johnson** / On Sugar: Memory and Memorial as Affective Archives

**3-10: Affective Ecologies and Everyday Emotional Economies (S17) - CHORAL**

- **Alec L. Foster** / Emotional Ecologies and Economies of Care in Philadelphia
- **Aurora Fredriksen** / Cats, crabs, conservation: The affects of eco-nostalgia and monstrous hybridities in everyday outdoor encounters
- **Matthew Tiessen** / Transpire the Mountains: Forests, Ubiquitous Computing, and the Affective Evolution of Urban Ecological Escapism
- **Gavin Weedon** / Mud, Premodern Nostalgia and Overcoming Obstacles in an 'Extreme' Endurance Sport

**3-11: Affective Methodologies (S15) – BINNS**

- **Esther Hitchen & Sam Slatcher** / Keeping alive the encounter through affective research practice
- **Louise Boisclair** / The Voice of the Event or How the self-creative force "Relax" deviates or absorbs the destructive forces in a Fall



- **Collin G. Brooke** / When Algorithms Attack! The Affective Consequences of Social Media
- **Trisha Campbell** / Voice Practice

**3-12: Anxieties and Petrifications (S1) – LOWER LEVEL 1-02 (Lisa Baraitser)**

- **Katie Gentile** / Fetal Bodies as Narcissistic Defense in the face of Hyperobjects
- **Christopher Chamberlin** / Affective Ankylosis: Fanon and the Petrification of Colonialism
- **Rachel Liebert** / Re-turning the magic: Using public art to experiment with the radical potential of paranoia
- **Tom Roach** / Becoming Fungible: Queer Intimacies in Social Media

***PLENARY #6: MELISSA GREGG & NATASHA DOW SCHÜLL***

***3:40 – 5:10 Steinman Hall (Chair: Jenny Sunden)***

**PANELS: SATURDAY OCT 17 – 5:25 until 7:05 pm**

**3-13: Transfigurations: Engaging Religious and Secular Affect (S13) – STEINMAN AUDITORIUM**

- **Denise Grollmus** / Feeling Addicted: Repurposing Religious Discourse in Narratives of Addiction
- **Jessica Johnson** / Testimonies to Trauma of Religious and Secular Affective Political Value
- **Deborah Gould** / Becoming Coalitional: The Strange Alliance between Queer to the Left and the Jesus People, USA
- **Sophie Bjork-James** / Epistemologies of Affect and Discourses of the Self: Learning to Feel God in US Evangelicalism

**3-14: Blackness, Performance and Protest (S2) – ATRIUM (Rizvana Bradley)**

- **James Ford III** / Concerning Violence”: Lauryn Hill, Frantz Fanon, and Anticolonial Inheritance
- **Christine Capetola** / “Hold That Pose for Me”: FKA twigs, Synthesized Sounds, and Vibrational Collectivity
- **Gerald Majer** / Feeling the Baltimore Vibe: Hapticality, Rhythm, and 'How We Party'
- **Taryn Jordan** / Black Fugitive Affect: The Hologram as the Loophole of Retreat

**3-15: Metaphors of Movement (S18) - GRAND SALON**

- **Luis-Manuel Garcia & Dorina M. Buda** / Moving (in) Feeling: Affective Theories in Sound and Tourism
- **Carolyn Veldstra** / Cynical Eddies: Affective Ambivalence and Neoliberalism's Sticking Points
- **Alina Haliliuc** / Cold Encounters: Emplaced Affect in Beyond the Hills
- **Michael A. Di Giovine** / From Pilgrimage to Heritage: Sensory Mechanisms of Religious and Secular Affect at the Italian Shrines to St. Padre Pio of Pietrelcina

**3-16: Posthuman Affects: New Feminist Epistemologies (S6) – CHORAL**

- **Vivienne Bozalek** / The Political Ethics of Care and Feminist Posthuman Ethics
- **Christine Filippone** / Eco-Art, Open Systems and the Affective Posthuman
- **Allyse Knox** / Programmable Affects? Critical Art Ensemble and the Future Uncanny

**3-17: Reading Human Rights and Literature Through Affect (S10) - BINNS**

- **Doro Wiese** / Twin Evil: Capitalism and Colonialism in Leslie Marmon Silko's *Almanach of the Dead*
- **Élise Couture-Grondin** / The Ordinary Violence of Colonialism in Rigoberta Menchú's Testimony: Decolonizing Affect in Literary Criticism
- **Katherine Hallemeier** / The Bureaucracy of Compassion in *Farming Ashes*
- **Helen Frost** / New Affective Horizons: Troubling Human Rights Discourse in Achamit Dangor's *Bitter Fruit*
- **Manav Ratti** / Affect After Apartheid: Human Rights and Representation in Sindiwe Magona's *Mother to Mother*

**3-18: Bodies in Motion and Sympathy (S16) – LOWER LEVEL 1-02**

- **Emanuela Bianchi** / Platonic Affects: Queer Inspiration and Corporeal Downgoing
- **Gizem Sözen** / Becoming a War Machine: Politics of Movement in Affection
- **Brooke Holmes** / Affective Communities in a Sympathetic Cosmos
- **Lara Farina** / That Old Dance: Moving Readers and the Forms of Affect Theory

***SEASONAL SOUPS & BREAD w/ #affectWTF CAKE! 7:05 – 8:45 pm***

***Ken Wissoker (Editorial Director: Duke University Press) hosts a PhD to Book Discussion  
with Q & A (bring your soup! Atrium 7:30-8:15)***

***PLENARY #7: ERIN MANNING, BRIAN MASSUMI & STEVEN SHAVIRO  
8:45 – 11:00 pm Steinman Hall (Chair: John Protevi)***

***Conference wraps at 11 pm!***

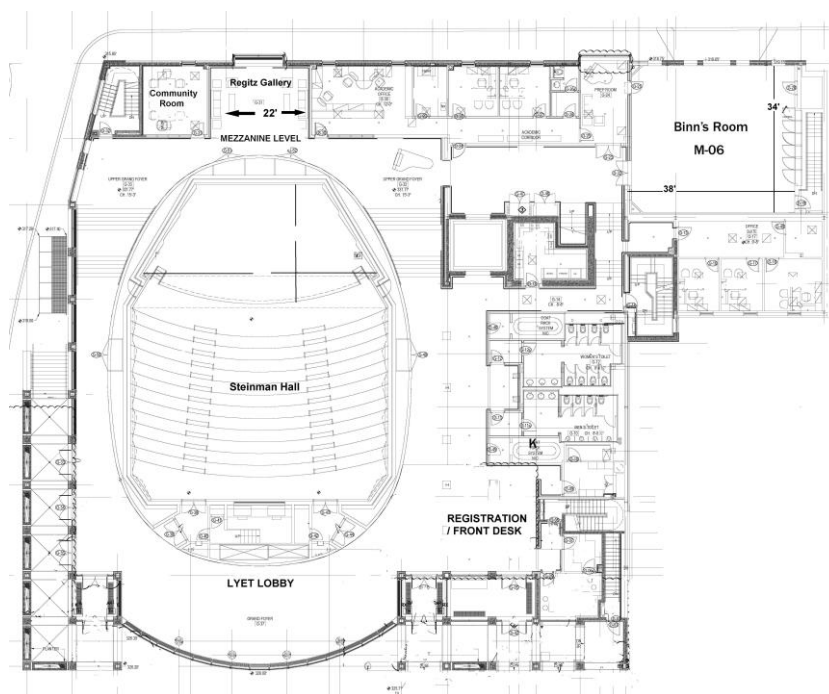

***Ware Center – Ground Floor***

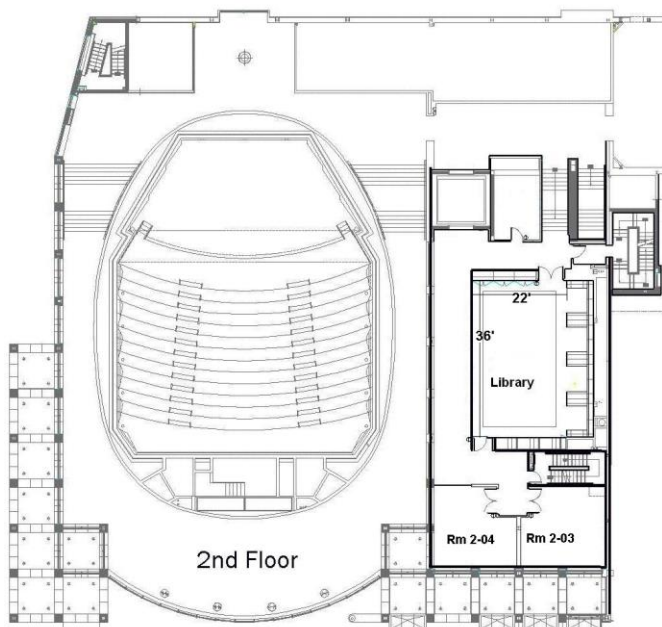



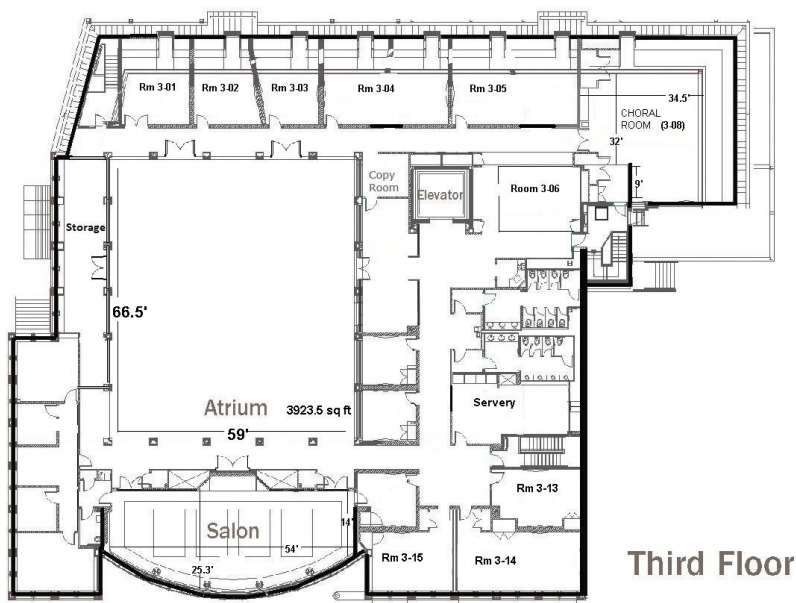

*Ware Center – Second Floor*



*Ware Center – Third Floor*

# The Ware Center

- The  
Ware  
Center 
- One  
way 
- Penn  
Square 
- Parking 

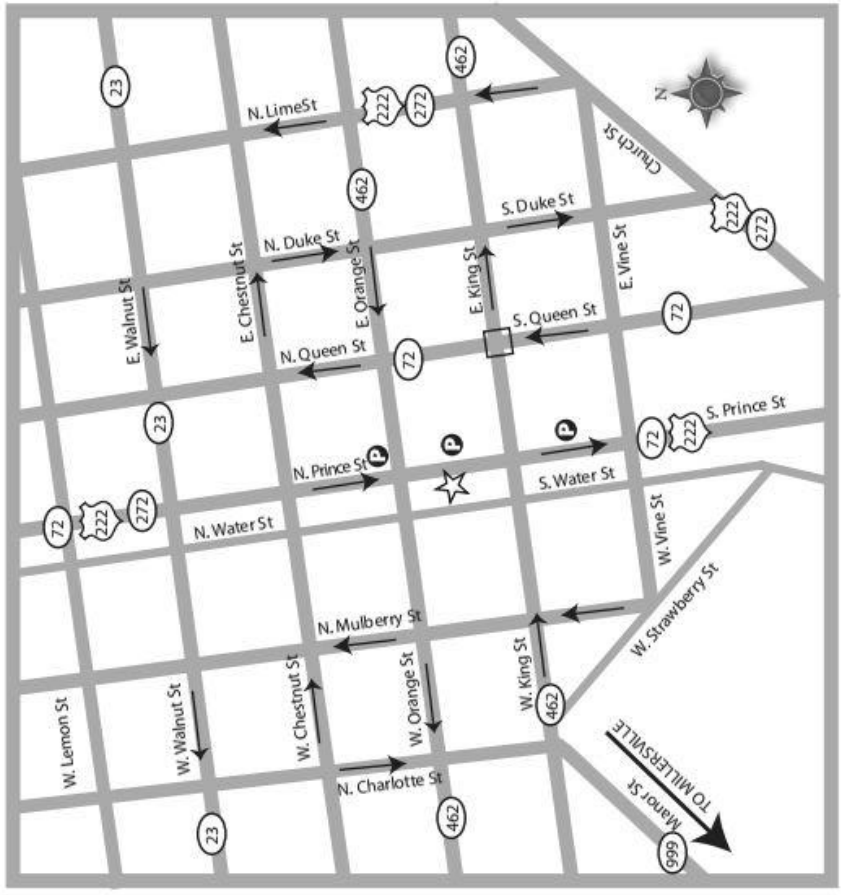

# Affect Books from SAGE Publications

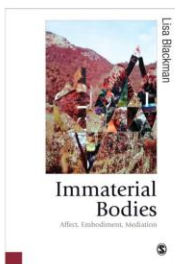

**Immaterial Bodies**  
Affect, Embodiment, Mediation  
Lisa Blackman

£29.99

**SM+S**  
social media  
+ society



**Social Media + Society**

An open-access journal committed to advancing the understanding of social media and its impact on societies past, present and future.

[www.sms.sagepub.com](http://www.sms.sagepub.com)

**Affect and Emotion**  
A New Social Science Understanding  
Margaret Wetherell

£27.99

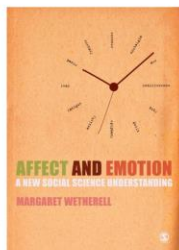

**Applied Positive Psychology**  
Integrated Positive Practice  
Tim Lomas, Kate Hefferon, Itai Ivztan

£26.99

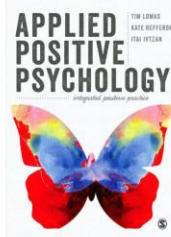

**Social Psychology of Emotion**  
Darren Ellis, Ian Tucker



**Social Psychology of Emotion**  
Darren Ellis, Ian Tucker

£24.99



**The Body & Social Theory**  
Third Edition

**The Body and Social Theory**  
THIRD EDITION  
Chris Shilling

£28.99



## Affect E-Special Issue

In honour of the Affect Theory Conference, we have prepared an E-special on the theme of affect. Content is drawn from *Body & Society* and *Theory Culture & Society*. You can access this collection freely throughout October.

<http://bod.sagepub.com/site/Affect-E-Special.xhtml>

You can also read the *Body & Society* special issue on Affect —Vol. 16 (1):

<http://bod.sagepub.com/content/16/1>



Follow us on twitter! @SAGESociology  
[www.sagepub.com](http://www.sagepub.com)

**SAGE**

**50**  
YEARS

Willful Subjects  
Sara Ahmed

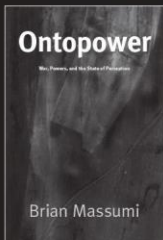
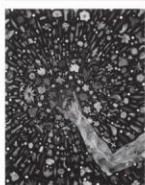

## Affect Theory titles from **DUKE UNIVERSITY PRESS**

*Save 30% with coupon code **ATC15!***

### **Ontopower**

War, Powers, and the State of Perception

**BRIAN MASSUMI**

1 illustration, paper, \$24.95

### **Cruel Optimism**

**LAUREN BERLANT**

58 illustrations, paper, \$24.95

### **Willful Subjects**

**SARA AHMED**

paper, \$24.95

### **The Promise of Happiness**

**SARA AHMED**

paper, \$24.95

### **Parables for the Virtual**

Movement, Affect, Sensation

**BRIAN MASSUMI**

*Post-Contemporary Interventions*

paper, \$24.95

### **Always More Than One**

Individuation's Dance

**ERIN MANNING**

Prelude by **BRIAN MASSUMI**

33 illustrations, paper, \$24.95

### **The Forms of the Affects**

**EUGENIE BRINKEMA**

10 illustrations (incl. 3 in color), \$25.95

*Follow us on Twitter!*  
**@DUKEpress**

888-651-0122  
[dukeupress.edu](http://dukeupress.edu)

**DUKE**  
UNIVERSITY PRESS



## **The Affective Turn**

Theorizing the Social

**PATRICIA TICINETO CLOUGH, editor**

with JEAN HALLEY

Foreword by MICHAEL HARDT

paper, \$24.95

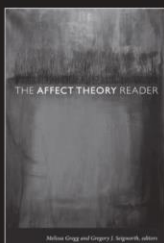

## **The Affect Theory Reader**

**MELISSA GREGG and**

**GREGORY J. SEIGWORTH, editors**

1 photograph, paper, \$26.95

## **Depression**

A Public Feeling

**ANN CVETKOVICH**

38 illustrations, (incl. 14 in color), paper, \$23.95

## **Touching Feeling**

Affect, Pedagogy, Performativity

**EVE KOSOFSKY SEDGWICK**

*Series Q*

paper, \$22.95



## **Ordinary Affects**

**KATHLEEN STEWART**

paper, \$19.94

## **Forthcoming:**

## **Obstruction**

**NICK SALVATO**

19 illustrations, \$24.95

## **Religious Affects**

Animality, Evolution, and Power

**DONOVAN O. SCHAEFER**

3 illustrations, paper, \$24.95

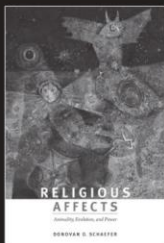

## **The Minor Gesture**

**ERIN MANNING**

*Thought in the Act*

22 photographs, paper, \$24.95

Follow us on Twitter!  
@DUKEpress

888-651-0122  
dukeupress.edu

**DUKE**  
UNIVERSITY PRESS



An abstract painting with a textured, painterly style. The color palette is dominated by warm tones: deep reds, oranges, yellows, and earthy browns. On the right side, there is a vertical, elongated shape that resembles a human figure or a draped garment, rendered in shades of yellow and orange. The background is a mix of these warm colors with some cooler, muted blues and greens on the left side. The overall effect is one of emotional intensity and organic form.

**#affectWTF**

© Claire Giblin